

NOTE:
 - Proposals must comply with all acoustic, fire & building regulation requirements
 - No dimensions are to be scaled from this drawing. The contractor is responsible for checking all dimensions on site

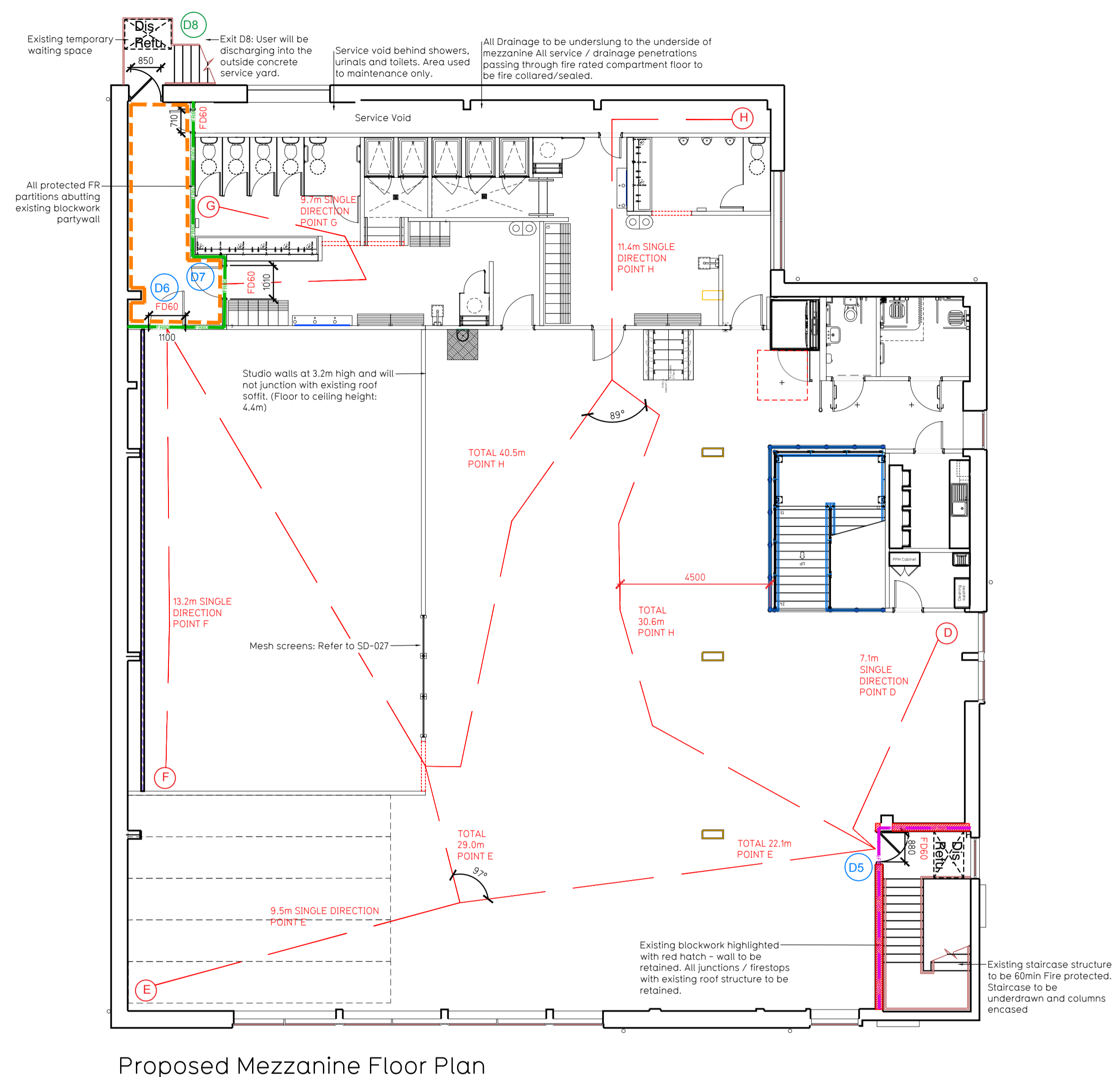
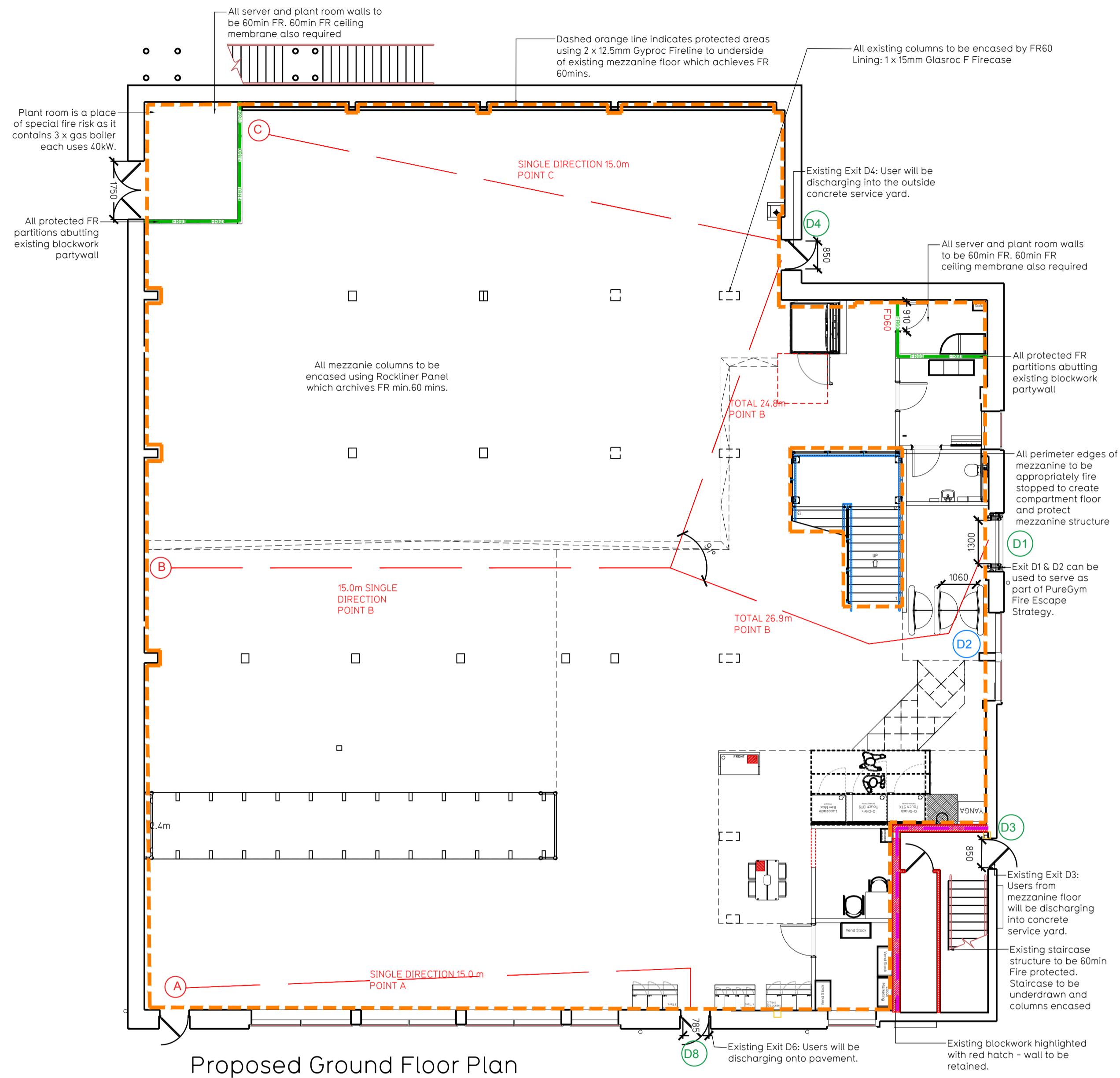

Escape Route Widths

In line with Section 2.9.8 of the Technical Handbook - Non Domestic, the aggregate unobstructed width in mm of all escape routes from a room, or storey, should be at least 5.3 x the occupancy capacity of the room or storey.

Ground Floor

Aggregate Clear Opening Width of Escape Routes Calculation:
 Final Fire Exit D1 clear opening width = 1060mm but is limited by D2 clear opening width = 1060mm
 Final Fire Exit D4 clear opening width = 850mm (allows max.225 persons to escape)
 Total Aggregate Width for Ground Floor (Less Largest Opening Width of 1060mm from D2) = 850mm
 Ground Floor Maximum Occupancy Capacity = 225 people (based on Scotland Building standards technical handbook 2022: non-domestic 2.9.8)

Mezzanine Floor

Aggregate Clear Opening Width of Escape Routes Calculation:
 Final Fire Exit D3 clear opening width = 850mm but is limited by D5 clear opening width = 850mm (allows max. 225 persons to escape)
 Final Fire Exit D8 clear opening width = 1060mm (allows max.225 persons to escape)
 Total Aggregate Width for Ground Floor (Less Largest Opening Width of 1100mm from D3) = 850mm
 Mezzanine Maximum Occupancy Capacity = 225 people (based on Scotland Building standards technical handbook 2022: non-domestic 2.9.8)

Combined Occupancy Provision

Ground floor maximum occupancy:	225
Mezzanine floor maximum occupancy:	225
Total occupancy provision:	450

The Mingavie Pure Gym is designed for an average peak occupancy of 207 which is smaller than the max. no of 450 persons (see calculation above). Therefore thought to meet with the Section 2.9 of Technical Handbook - Non Domestic.

It is important to note that 207 people is the peak occupancy figure. Pure Gym Mingavie's average occupancy during everyday operation will likely be approx. 50% lower than peak hour occupancy.

The average peak occupancy operational occupancy of 207 people derives from the vast amount of data collected via 340+ Pure Gyms of comparable size: data collection is conducted through access control ironmongery at turnstiles and can be viewed on Pure Gym app and website.

Escape Distance and Angle of Divergence

Position A
 Total escape to nearest Final Exit D8 = 15.0m

Position B
 Total escape distance to nearest Final Exit D1 = 24.8m
 Distance before divergence is 15m
 A.O.D to be > (2.5 x 15) ÷ 45 = 82.5°
 Drawn A.O.D = 91° thus complies

Position C
 Total escape to nearest Final Exit D4 = 15.0m

Position D
 Total escape to nearest Final Exit D5 = 7.1m
 The total escape distance is less than 15m and thus complies.

Position E
 Total escape distance to nearest Final Exit D5 = 22.1m
 Distance before divergence is 9.5m
 A.O.D to be > (2.5 x 9.5) ÷ 45 = 68.75°
 Drawn A.O.D = 89° thus complies

Position F
 Total escape to nearest Final Exit D6 = 13.5m
 The total escape distance is less than 15m and thus complies.

Position G
 Total escape to nearest Final Exit D7 = 9.7m
 The total escape distance is less than 15m and thus complies.

Position H
 Total escape distance to nearest Final Exit D5 = 30.6m
 Distance before divergence is 11.4m
 A.O.D to be > (2.5 x 11.4) ÷ 45 = 67.8°
 Drawn A.O.D = 89° thus complies

Fire Evacuation Key

	Existing wall to achieve min 30 minute fire rating (suitability of wall to be confirmed on site by Pure Gym Main Contractor)		Fire Escape Route
	Existing wall to achieve min 60 minute fire rating (suitability of wall to be confirmed on site by Pure Gym Main Contractor)		Exit No.
	New wall to achieve min of 30min fire rating		Shared Escape Route
	New wall to achieve min of 60min fire rating		Fire Door Rating
	Protected areas: walls, floors, ceilings and doors to achieve 30minute fire resistant construction.		
	Protected areas: walls, floors, ceilings and doors to achieve 60 minute fire resistant construction.		

Sprinklers
 System design and installed in compliance with BS EN 12845:2015 & LPC Technical Bulletins

Fire Alarm
 Fire Alarm designed and installed to BS 5839. Smoke & heat detection / emergency lighting by specialist. Please refer to MSE engineer's drawings / specifications.

Escape Lighting
 Emergency escape lighted designed and installed in accordance with BS 5266: Part 1. Please refer to MSE Engineer's drawings for final layout and specification.

Smoke Extract
 Smoke Extract System to be designed and installed in accordance with BS 7346: Part 8. Please refer to MSE Engineer's drawings for final layout and specification.

Fire Stopping
 All perimeter edges of mezzanine to be appropriately fire stopped to create compartment floor and protect mezzanine structure. All services/drainage penetrations passing through fire rated compartment floor to be fire collared/sealed.

Escape Signage and emergency lighting is CDP under the MSE specification. Details of contractors proposals to be provided to Building Control Approved Inspector and Fire Officer within the Contractors Proposals Package, Clause 14

Rev	Date	Description	Drawn/Checked
<p>Mingavie 110-112 Main St, Mingavie, Glasgow G62 6JN</p> <p>Fire Evacuation Plan Ground and Mezzanine Floor Plans</p> <p>SK/KL 11.07.23 1:100 @ A1 2264 003-FEP</p> <p>CONSTRUCTION C00</p>			
			Pure Gym Ltd Town Centre House The Merrion Centre Leeds LS2 9LY e: architecture@puregym.com t: 0113 285 8787 w: www.puregym.com