

Proposed Ground Floor Plan
Fire Exit (Scale 1:100)

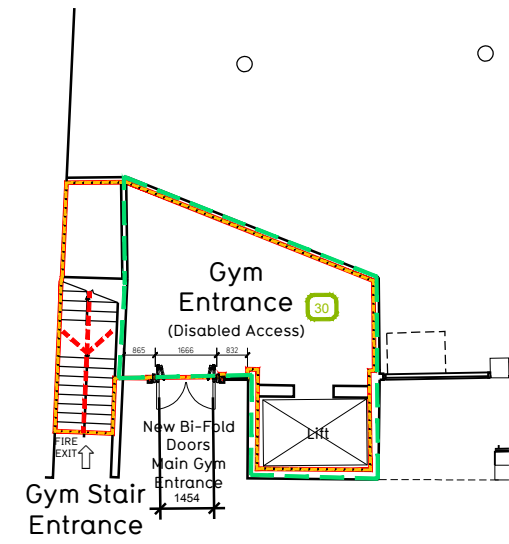

Proposed Ground Floor Plan
Entrance Area (Scale 1:100)



Proposed First Floor Plan (Scale 1:100)

Fire Evacuation Key

	Existing wall to achieve min 60 minute fire rating (suitability of wall to be confirmed on site by Pure Gym Main Contractor)		Occupancy level within area
	New wall to achieve min of 60min fire rating		Escape Route Unprotected
	Protected areas: walls, floors, ceilings and doors to achieve 30minute fire resistant construction.		Escape Direction Angle
	Protected areas: walls, floors, ceilings and doors to achieve 60 minute fire resistant construction.		Escape Route Protected/Shared
	FD60 - Fire Door 60min Resistance.		Minimum Clear Widths
	Disabled Refuge Area - 900 x 1400mm		Exit No.

Escape Route Widths

In line with Sections 3.21 & 3.22 of 'Approved Document Part B, Volume 2 - buildings other than dwellings' - the adjacent calculations provide justification for the clear opening widths for escape from each floor level/ room in accordance with Table 4 & Appendix C.

Ground Floor

Exit 1 Clear Opening Width - 850mm (allows 10 persons to escape)
 Exit 2 Clear Opening Width - 850mm (allows 10 persons to escape discounted)
 Total Aggregate Width for Floor (Less Largest Opening Width of 850mm from Exit 2) - 850mm
 Ground Floor Total Estimated Occupancy Capacity - 110 Persons
 Exit 1 provides a min. width of 850mm and would allow a max. No. of 10 persons to escape and is therefore thought to meet with the Approved Document Part B.

Sprinklers

System design and installed in compliance with BS EN 12845:2015 & LPC Technical Bulletins

Fire Alarm

Fire Alarm designed and installed to BS 5839: Smoke & heat detection / emergency lighting by specialist. Please refer to M&E engineer's drawings / specifications.

Escape Lighting

Emergency escape lighting designed and installed in accordance with BS 5266: Part 1. Please refer to M&E Engineer's drawings for final layout and specification.

Rev	Date	Description	Drawn/	Checked
PROJECT TITLE		DRAWING TITLE		
SBF - Hitchin		Fire Evacuation Plan		
18-19 Brand Street, Hitchin, Hertfordshire, SG5 1JE		Ground & First Floor Plan		
DRAWN / CHECKED	DATE	SCALE	JOB NO.	DRAWING NO.
EK/PG	10.11.18	1:100@A1 / 1:200@A3	IA-SBF-007	003 FEP
CONSTRUCTION				
Pure Gym Ltd Town Centre House The Merrion Centre Levels LS2 8LY e: architecture@puregym.com t: 01132182674 w: www.puregym.com				