

Proposed Ground Floor Plan

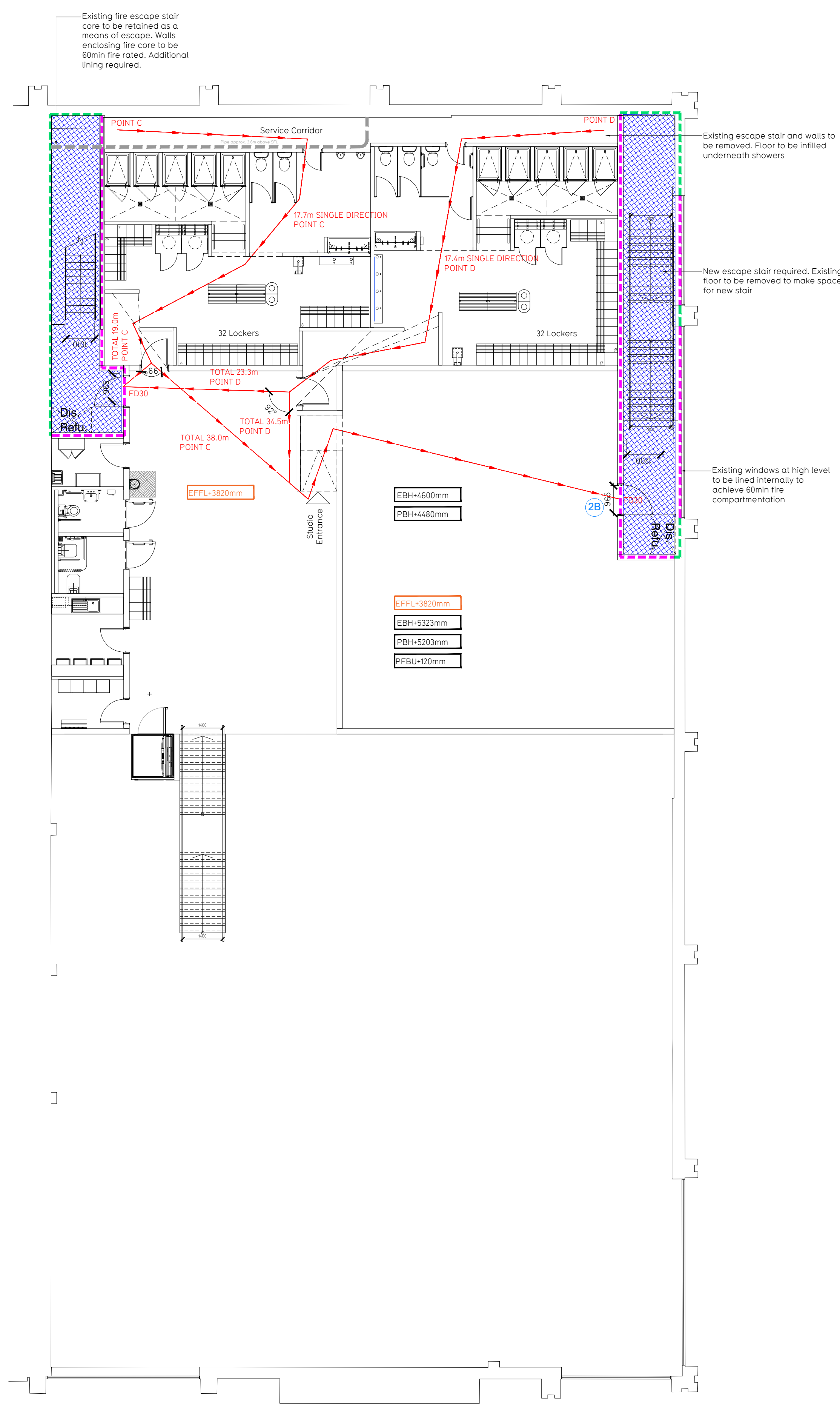

Proposed Mezzanine Floor Plan

NOTE:

- Proposals must comply with all acoustic, fire & building regulation requirements.
- No dimensions are to be scaled from this drawing. The contractor is responsible for checking all dimensions on site.
- Front half of mezzanine (stepped areas) to be removed. Existing original mezzanine to be retained. Mezzanine sub-contractor to ensure structure is fire-rated and make good any damaged areas. Existing mezzanine slab to be infilled where required (e.g. where stairs have been removed) and opened where required (e.g. for new stair).
- Refer to demolition plan for extent of removal.
- Tiled floor at ground level to be removed. Entrance thresholds to be made good.
- All existing roller shutters to be removed.
- All partitions to be removed.

Fire Evacuation Key

- Existing wall to achieve min 30 minute fire rating (suitability of wall to be confirmed on site by Pure Gym Main Contractor)
- Existing wall to achieve min 60 minute fire rating (suitability of wall to be confirmed on site by Pure Gym Main Contractor)
- New wall to achieve min of 30min fire rating
- New wall to achieve min of 60min fire rating
- Protected areas: walls, floors, ceilings and doors to achieve 30minute fire resistant construction.
- Protected areas: walls, floors, ceilings and doors to achieve 60 minute fire resistant construction.
- Fire Escape Route
- Minimum Clear Widths
- Exit No.
- Shared Escape Route

Escape Route Widths:
In line with Sections 3.21 & 3.22 of 'Approved Document Part B, Volume 2 - buildings other than dwellings' - the adjacent calculations provide justification for the clear opening widths for escape from each floor level/ room in accordance with Table 4.4 Appendix C.

Ground Floor
Exit 1 is restricted by Exit 1A Clear Opening Width = 1020mm (allows 234 persons to escape)
Exit 2 is restricted by Exit 2A Clear Opening Width = 1338mm (allows 277 persons to escape, largest opening to be discounted)
Total Aggregate Width for Floor (Less Largest Opening Width of 1338mm from EXIT NO. 2A = 1020mm)
Total Estimated Average Peak Occupancy Capacity = 238 Persons
Exit 1A provides a min. width of 1020mm and would allow a max. No. of 234 persons to escape, which is larger than the total estimated Average Peak occupancy capacity of 238 Persons and is therefore thought to meet with the Approved Document Part B.

Mezzanine Floor
Exit 3 Clear Opening Width = 906mm (allows 110 persons to escape)
Exit 2 is restricted by Exit 2B Clear Opening Width = 906mm (allows 110 persons to escape, largest opening to be discounted)
Total Aggregate Width for Floor (Less Largest Opening Width of 906mm from EXIT NO. 3 = 906mm)
Exit 3 provides a min. width of 906mm and would allow a max. No. of 110 persons to escape, which is equivalent to half of the total estimated Average Peak occupancy capacity of 238 Persons and is therefore thought to meet with the Approved Document Part B.

Final Exits
Exit 1 Clear Opening Width = 2000mm (escape occupancy limited by Exit 1A = 234 persons)
Exit 2 Clear Opening Width = 1802mm (determined by merge in flow calculation for escape from Ground Floor Exit 2A and mezzanine Exit 2B)
Exit 3 Clear Opening Width = 906mm (allows 110 persons to escape)

Exit 1 caters for ground floor only (via exit 1A) and allows the ground floor occupancy to escape and is thought to meet with the Approved Document Part B.
Exit 2 caters for the ground and mezzanine floor. Taking into account the merge in flow calculation of Approved Document Part B, a stair width of 1000mm and a final exit width of 1802mm means that Exit 2 is capable of accommodating the 370 persons from Exit 2A and the additional 277 occupants escaping via Storey Exit D. Given the over provision of fire exits at Ground Floor this is therefore thought to meet with Approved Document Part B.
Exit 3 caters for Mezzanine floor only and allows the mezzanine floor occupancy to escape and is thought to meet with the Approved Document Part B.

Fire Alarm
Fire Alarm designed and installed to BS 5833. Smoke & heat detection / emergency lighting by specialist. Please refer to M&E engineer's drawings / specifications.

Escape Lighting
Emergency escape lighted designed and installed in accordance with BS 5266: Part 1. Please refer to M&E Engineer's drawings for final layout and specification.

Escape Signage and emergency lighting is CDP under the M&E specification. Details of contractors proposals to be provided to Building Control Approved Inspector and Fire Officer within the Contractors Proposals Package, Clause 1.4

Rev	Date	Description	Drawn/Checked
C05	15.03.23	Fix Floor Finishes and Spin podium relocation. Refer to latest GA drawing. No change to Fire Plan details.	MJI/JM
C04	10.03.23	Minor update to existing building structure as per latest GA plan. Server room all /door moved 400mm to allow for larger server unit, wall ref line updated.	MJI/JM
C03	27.02.23	Plant Room & wall linings updated. MZ wall positions updated.	SKI/JM
C02	23.02.23	Male WC walls updated. Mezz. wall types updated.	SKI/JM
C01	14.02.23	Lift support wall added. Vanity stations revised. Female changing wall added.	SKI/MM

PROJECT TITLE	DRAWING TITLE			
Centurion Retail Park, York Road Doncaster, DN5 9TP	Fire Evacuation Plan Ground and Mezzanine Floor Plans			
DRAWN / CHECKED	DATE	SCALE	ISS. NO.	DRAWING NO.
SK/HB/MJI	11.01.23	1:100 @ A1	2140	003-FEP
DRAWING PURPOSE	CONSTRUCTION	REV		
		C05		

Pure Gym Ltd
Town Centre House
The Merlion Centre
Leeds
LS2 9LY
e: architecture@puregym.com
t: 0113 285 6787
w: www.puregym.com