

- NOTE:
- Proposals must comply with all acoustic, fire & building regulation requirements
  - No dimensions are to be scaled from this drawing. The contractor is responsible for checking all dimensions on site

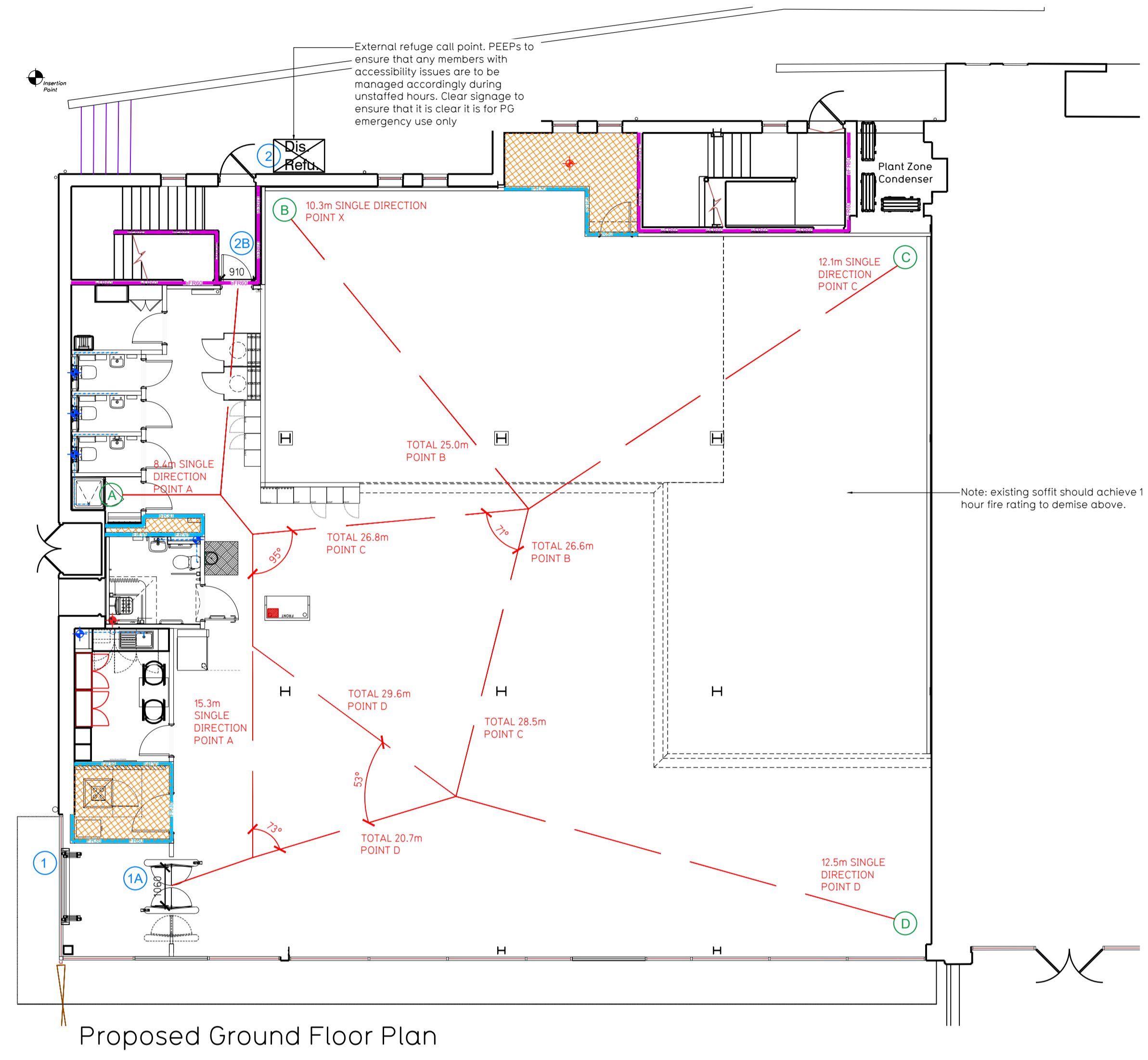

Proposed Ground Floor Plan

**Fire Evacuation Key**

	Existing wall to achieve min 30 minute fire rating (suitability of wall to be confirmed on site by Pure Gym Main Contractor)		Fire Escape Route
	Existing wall to achieve min 60 minute fire rating (suitability of wall to be confirmed on site by Pure Gym Main Contractor)		Minimum Clear Widths
	New wall to achieve min of 30min fire rating		Exit No.
	New wall to achieve min of 60min fire rating		Shared Escape Route
	Protected areas: walls, floors, ceilings and doors to achieve 30minute fire resistant construction.		FD30 / FD60 Fire Door Rating - 30min. / 60min.
	Protected areas: walls, floors, ceilings and doors to achieve 60 minute fire resistant construction.		FDKS / AFDK / FDKL Fire Door Signage - Fire Door Keep Shut / Automatic Fire Door Keep Clear / Fire Door Keep Locked

**Escape Route Widths:**  
In line with Sections 3.21.6, 3.22 of 'Approved Document Part B, Volume 2 - buildings other than dwellings' - the adjacent calculations provide justification for the clear opening widths for escape from each floor level/ room in accordance with Table 4 & Appendix C.

**Ground Floor:**  
Exit 1a restricted by 1A, Exit 1a Clear Opening Width = 1060mm (allows 222 persons to escape)  
Exit 2 is restricted by 2B, Exit 2B Clear Opening Width = 910mm (allows 110 persons to escape) largest opening to be discounted  
Total Aggregate Width for Floor (Less Largest Opening Width of 910 from A = 310mm allows 110 persons to escape)

**Total:**  
Total = 110 persons to escape  
Based on a NIA of 589 sqm, the Puregym Peak Occupancy Target = 100 Persons  
Calculated using Puregym Fire Safety Occupancy Levels Forecast Tool.

The designed occupancy of the unit as calculated below would allow a max. No. of 110 persons to escape, which is larger than the total estimated occupancy capacity of 100 Persons and is therefore thought to meet with the Approved Document Part B.

**Fire Alarm**  
Fire Alarm designed and installed to BS 5839. Smoke & heat detection / emergency lighting by specialist. Please refer to M&E engineer's drawings / specifications.

**Escape Lighting**  
Emergency escape lighted designed and installed in accordance with BS 5266: Part 1. Please refer to M&E Engineer's drawings for final layout and specification.

**Fire Stopping**  
All perimeter edges of mezzanine to be appropriately fire stopped to create compartment floor and protect mezzanine structure. All services/drainage penetrations passing through fire rated compartment floor to be fire collared/sealed.

Escape Signage and emergency lighting is CDP under the M&E specification. Details of contractors proposals to be provided to Building Control Approved Inspector and Fire Officer within the Contractors Proposals Package, Clause 1.4

Rev	Date	Description	Drawn/Checked
C00	12.08.24	Construction issue	CS/PG
T02	21.06.24	Outdoor condenser unit updated	CS/WLT
T01	25.04.24	Acoustic measures updated to suit use of space above	CS/PG

<b>PROJECT TITLE</b>		<b>DRAWING TITLE</b>	
Droitwich Spa Unit 41/42, Saint Andrews Square, WR9 8HE		Fire Evacuation Plan Ground Floor Plan	
<b>DRAWN/ISSUED BY</b>	<b>DATE</b>	<b>SCALE</b>	<b>DOC No.</b>
KMC/CS	11.03.24	1:100 @ A1	2382
<b>DRAWING PURPOSE</b>			<b>Rev</b>
CONSTRUCTION			C00

**PUREGYM**

Pure Gym Ltd  
Town Centre House  
The Merrion Centre  
Leeds  
LS2 8LY

e: [architecture@puregym.com](mailto:architecture@puregym.com)  
t: 0113 285 8787  
w: [www.puregym.com](http://www.puregym.com)