

NOTE:

- Proposals must comply with all acoustic, fire & building regulation requirements
- No dimensions are to be scaled from this drawing. The contractor is responsible for checking all dimensions on site

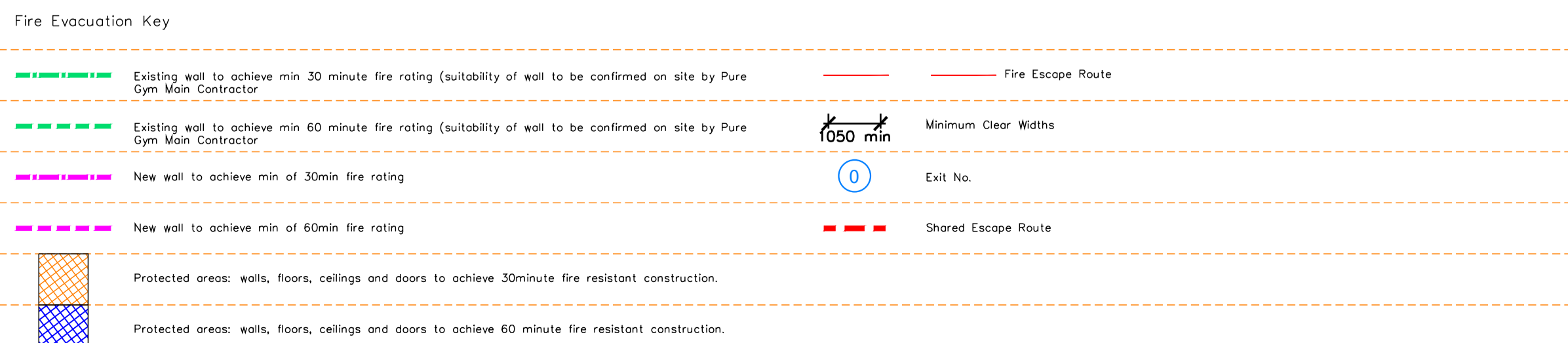
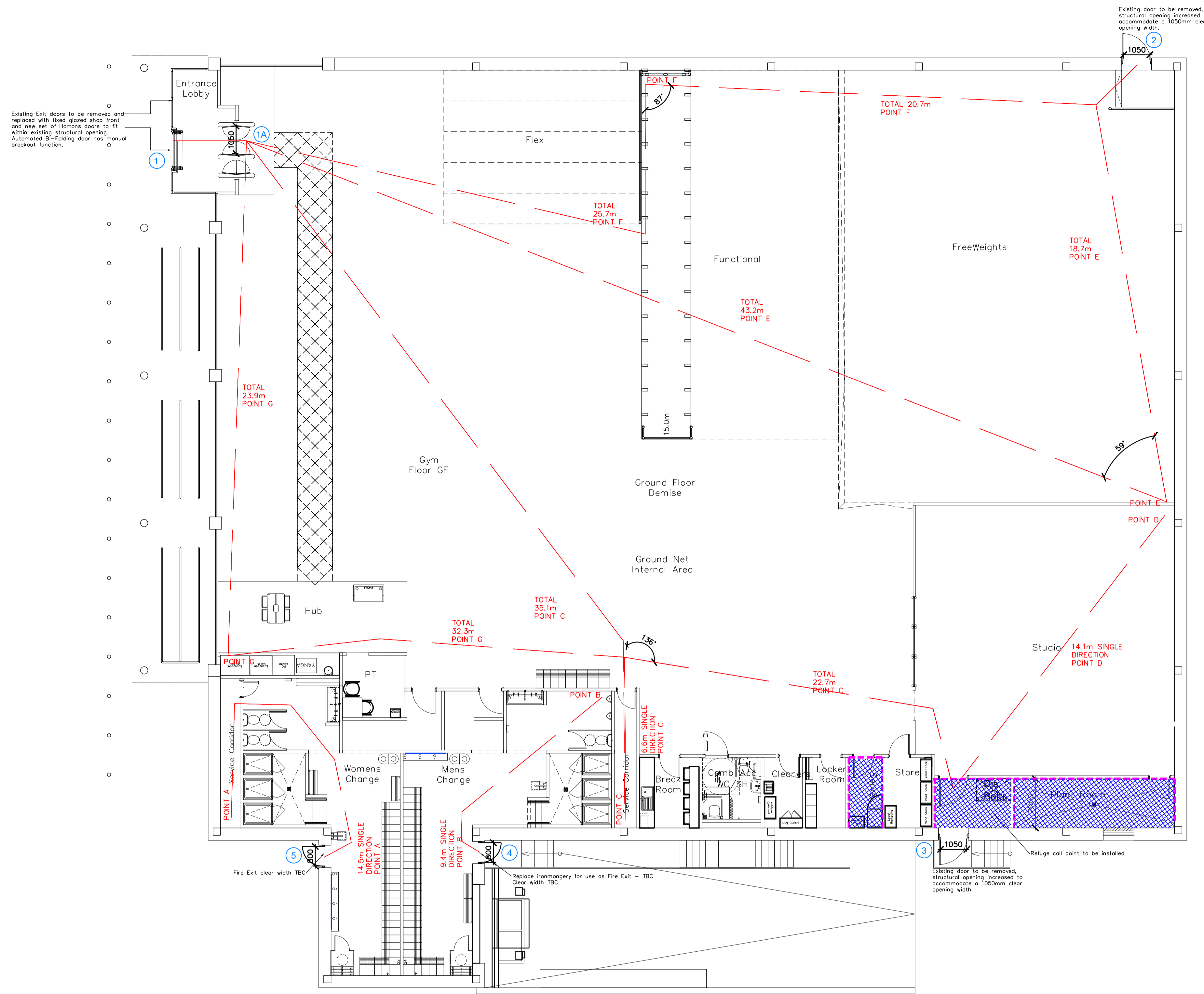

Escape Route Widths:
 In line with Sections 3.21 & 3.22 of 'Approved Document Part B, Volume 2 - buildings other than dwellings' - the adjacent calculations provide justification for the clear opening widths for escape from each floor level/ room in accordance with Table 4 & Appendix C.

Ground Floor:
 Exit 1 is restricted by Exit 1A Clear Opening Width = 1050mm (allows 220 persons to escape, largest opening to be discounted)
 Exit 2 Clear Opening Width = 1050mm (allows 220 persons to escape)
 Exit 3 Clear Opening Width = 1050mm (allows 220 persons to escape)
 Exit 4 Clear Opening Width = 800mm (allows 60 persons to escape)
 Exit 5 Clear Opening Width = 800mm (allows 60 persons to escape)

Total Aggregate Width for Floor (Less Largest Opening Width of 1050mm from Exit 1A = 3700mm)

Based on NIA of 7207sqft, the Puregym Average Peak occupancy target = 194 Persons
 Calculated using Puregym Fire Safety Occupancy Levels Forecast Tool.

The designed occupancy of the unit as calculated would allow a max. No. of 560 persons to escape, which is larger than the total estimated occupancy capacity of 194 persons and is therefore thought to meet with the Approved Document Part B.

Sprinklers
 System design and installed in compliance with BS EN 12845:2015 & LPC Technical Bulletins

Fire Alarm
 Fire Alarm designed and installed to BS 5839. Smoke & heat detection / emergency lighting by specialist. Please refer to M&E engineer's drawings / specifications.

Escape Lighting
 Emergency escape lighting designed and installed in accordance with BS 5266: Part 1. Please refer to M&E Engineer's drawings for final layout and specification.

Escape Signage and emergency lighting is CDP under the M&E specification. Details of contractors proposals to be provided to Building Control Approved Inspector and Fire Officer within the Contractors Proposals Package, Clause 1.4

Rev	Date	Description	Drawn/Checked
C01	16.01.23	Plant Room, Server Room Layout Update.	CV
C00	14.12.22	Construction Issue.	CV
T01	14.10.22	Entrance lobby updated	OT/RR

PROJECT TITLE		DRAWING TITLE	
Ipswich East Units 4-10, Hening Ave., Ipswich, IP3 9QJ		Fire Evacuation Plan Ground Floor Plan	
DRAWING CHECKED	DATE	SCALE	DWG No.
SK/PG	08.06.22	1:100 @ A1	2141
DRAWING PURPOSE			003-FEP
CONSTRUCTION			Rev
			C01

Pure Gym Ltd
 Town Centre House
 The Merrion Centre
 Leeds
 LS2 8LY
 e: architecture@puregym.com
 t: 0113 285 8787
 w: www.puregym.com