

NOTE:

- Proposals must comply with all acoustic, fire & building regulation requirements
- No dimensions are to be scaled from this drawing. The contractor is responsible for checking all dimensions on site

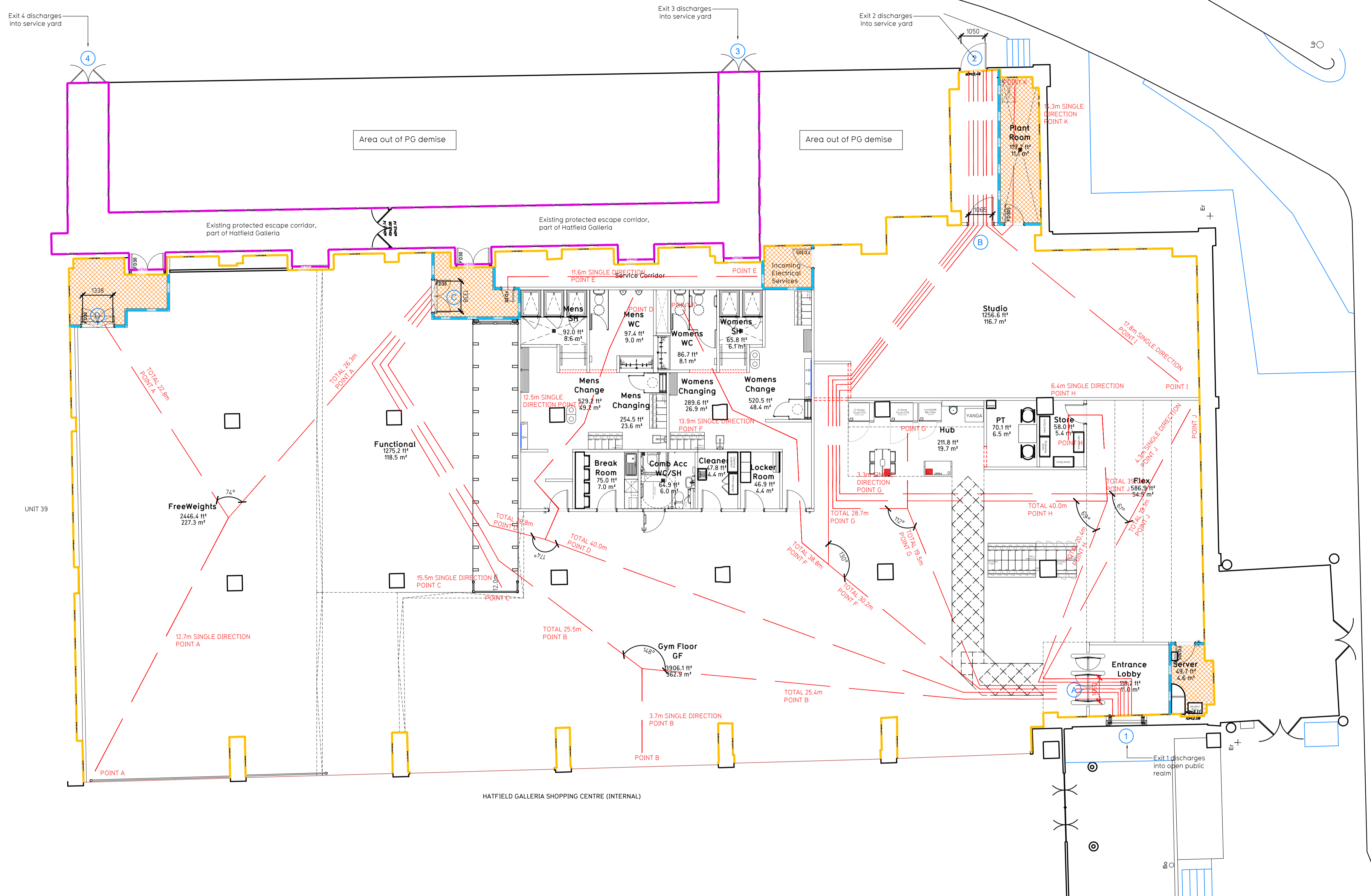

Ground Floor Plan

Fire Evacuation Key	
	Existing wall to achieve min 30 minute fire rating (suitability of wall to be confirmed on site by Pure Gym Main Contractor)
	Existing wall to achieve min 60 minute fire rating (suitability of wall to be confirmed on site by Pure Gym Main Contractor)
	New wall to achieve min of 30min fire rating
	New wall to achieve min of 60min fire rating
	Protected areas: walls, floors, ceilings and doors to achieve 30minute fire resistant construction.
	Protected areas: walls, floors, ceilings and doors to achieve 60 minute fire resistant construction.
	Fire Escape Route
	Minimum Clear Widths
	Exit No.
	Shared Escape Route
	Fire Door Rating

**Escape Route Widths:**  
 Following to be read in conjunction with Initial Fire Strategy Review by Jensen Hughes, Hatfield Galleria Fire Strategy and BS9999, Risk Profile B2 (Occupants aware and unalimbed with building). This would result in single actual travel distance of 20m and two-way actual travel distance of 50m. Based on the risk profile a min requirement of 4.1mm width per person is required.

Exit 1 is restricted by A. Exit A Clear Opening Width = 1060mm (allows 258 persons to escape)  
 Exit 2 is restricted by B. Exit B Clear Opening Width = 1060mm (allows 258 persons to escape)  
 Exit 3 is restricted by C. Exit C Clear Opening Width = 1338mm (allows 326 persons to escape)  
 Exit 4 is restricted by D. Exit D Clear Opening Width = 1338mm (allows 326 persons to escape, largest opening to be discounted)  
 Total Aggregate Width for Floor (Less Largest Opening Width of 1338mm from Exit D) = 2025mm

**Total = 643 persons to escape**

Based on a NIA of 10223 sqft, the Puregym Max Peak Occupancy Target = 207 Persons  
 Calculated using Puregym Fire Safety Occupancy Levels Forecast Tool.

The designed occupancy of the unit as calculated above would allow a max. No. of 643 persons to escape, which is larger than the total estimated occupancy capacity of 207 Persons and is therefore thought to meet with the Approved Document Part B.

**Sprinklers**  
 System design and installed in compliance with BS EN 12845:2015 & LPC Technical Bulletins

**Fire Alarm**  
 Fire Alarm designed and installed to BS 5839. Smoke & heat detection / emergency lighting by specialist. Please refer to MSE engineer's drawings / specifications.

**Escape Lighting**  
 Emergency escape lighting designed and installed in accordance with BS 5266: Part 1. Please refer to MSE Engineer's drawings for final layout and specification.

**Smoke Extract**  
 Smoke Extract System to be designed and installed in accordance with BS 7346: Part 8. Please refer to MSE Engineer's drawings for final layout and specification.

**Escape Signage and emergency lighting** is CDP under the MSE specification. Details of contractors proposals to be provided to Building Control Approved Inspector and Fire Officer within the Contractors Proposals Package, Clause 14.

Rev	Date	Description	Drawn/Checked
C02	09.11.23	FR to service corridor removed. Note added to protected lobbies for clarity	CS
C01	16.10.23	Reference figures adjusted to suit BS9999 and Hatfield Centre Strategy.	CS

PROJECT TITLE		DRAWING TITLE	
Hatfield Unit 40-45, Hatfield Galleria, Hatfield, AL10 0XR		Fire Evacuation Plan Ground Floor Plan	
DATE	SCALE	NO. IN SET	DRAWING NO.
20.10.23	1:100 @ A1	2189	003-FEP
DRAWING PURPOSE		Rev	
CONSTRUCTION		C02	

Pure Gym Ltd  
 Town Centre House  
 The Merrion Centre  
 Leeds  
 LS2 8LY  
 e: architecture@puregym.com  
 t: 0113 285 8787  
 w: www.puregym.com